



WORK ZONE DIVIDERS

ezoBord



ezoBord Work Zone Dividers add privacy, color and style, making every office space a better place to work in.

Divide space, absorb sound and create visual privacy all in one simple solution...

ezoBord Work Zone Dividers are cut in various shapes and patterns ranging from organic shapes to geometric shapes to cityscapes. A great way to define space quickly and cost effectively.

Made with recycled plastic water bottles.

STANDARD SHAPES



Aztec



Bamboo



Bubble



Chevron



Circles



Cube

PART NUMBER	WIDTH	HEIGHT	THICKNESS
Aztec			
wzd-azt-4896	47½" (1207mm)	95" (2413mm)	⅜" (9mm)
Bamboo			
wzd-bam-4896	47½" (1207mm)	95" (2413mm)	⅜" (9mm)
Bubble			
wzd-bub-4896	47½" (1207mm)	95" (2413mm)	⅜" (9mm)
Chevron			
wzd-che-4896	47½" (1207mm)	95" (2413mm)	⅜" (9mm)
Circles - Standard Circle is 1" (25mm) diameter			
wzd-cir-4896	47½" (1207mm)	95" (2413mm)	⅜" (9mm)
Cube			
wzd-cub-4896	47½" (1207mm)	95" (2413mm)	⅜" (9mm)

Please note that all dimensions are nominal, supplier reserves the right to adjust sizing without prior notification.

STANDARD SHAPES



Daire



Deco



Dokuma

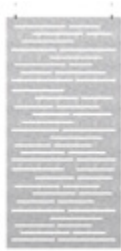

Flatline



Galaxy



Kesik

PART NUMBER	WIDTH	HEIGHT	THICKNESS
Daire			
wzd-dai-4896	47½" (1207mm)	95" (2413mm)	⅜" (9mm)
Deco			
wzd-dec-4896	47½" (1207mm)	95" (2413mm)	⅜" (9mm)
Dokuma			
wzd-dok-4896	47½" (1207mm)	95" (2413mm)	⅜" (9mm)
Flatline			
wzd-fla-4896	47½" (1207mm)	95" (2413mm)	⅜" (9mm)
Galaxy			
wzd-glx-4896	47½" (1207mm)	95" (2413mm)	⅜" (9mm)
Kesik			
wzd-kes-4896	47½" (1207mm)	95" (2413mm)	⅜" (9mm)

Please note that all dimensions are nominal, supplier reserves the right to adjust sizing without prior notification.

STANDARD SHAPES



Lazer



Leaf



Orman



Palm



Pixelated Circles

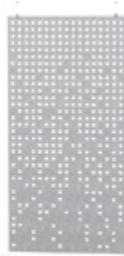

Pixelated Squares

PART NUMBER	WIDTH	HEIGHT	THICKNESS
Lazer			
wzd-lzr-4896	47½" (1207mm)	95" (2413mm)	⅜" (9mm)
Leaf			
wzd-lef-4896	47½" (1207mm)	95" (2413mm)	⅜" (9mm)
Orman			
wzd-orm-4896	47½" (1207mm)	95" (2413mm)	⅜" (9mm)
Palm			
wzd-pal-4896	47½" (1207mm)	95" (2413mm)	⅜" (9mm)
Pixelated Circles - Standard Circle is 1" (25mm) diameter			
wzd-pxc-4896	47½" (1207mm)	95" (2413mm)	⅜" (9mm)
Pixelated Squares - Standard Square is 1" (25mm) x 1" (25mm)			
wzd-pxs-4896	47½" (1207mm)	95" (2413mm)	⅜" (9mm)

Please note that all dimensions are nominal, supplier reserves the right to adjust sizing without prior notification.

STANDARD SHAPES



Rectangular Undulation



Squares

PART NUMBER	WIDTH	HEIGHT	THICKNESS
Rectangular Undulation			
wzd-rec-4896	47½" (1207mm)	95" (2413mm)	⅜" (9mm)
Squares - Standard Square is 1" (25mm) x 1" (25mm)			
wzd-sqr-4896	47½" (1207mm)	95" (2413mm)	⅜" (9mm)

Please note that all dimensions are nominal, supplier reserves the right to adjust sizing without prior notification.

COMPONENTS

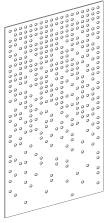

Work Zone Divider

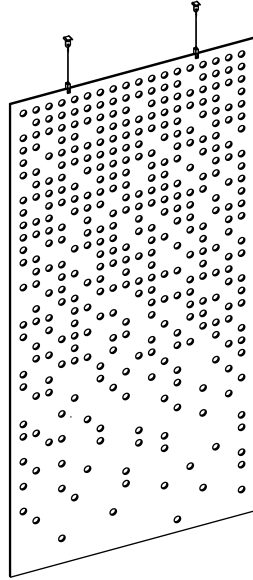

OPTIONAL HARDWARE (NOT INCLUDED)

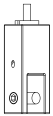

Ezo clamp
CBG-C Combo



Upper Suspension Housing
CF6-01

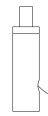

Height adjustable wire
ratchet
CG7210

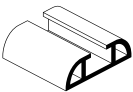

Wire suspension
track
XC-04

SLIDING TRACK SYSTEM

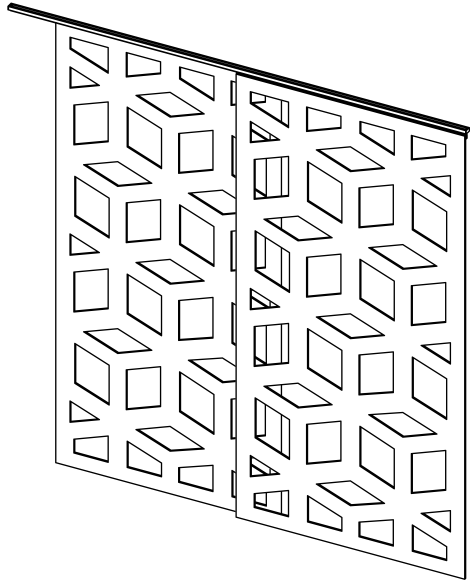

INCLUDED HARDWARE

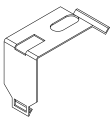

Ceiling Clip

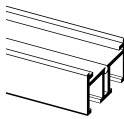

Track

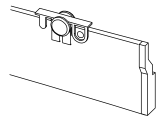

Runner

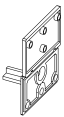

End Caps

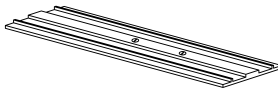

Bridge (Optional)



CUSTOMIZABLE PARAMETERS

Geometric Properties

Length and width

Material Thickness

$\frac{3}{8}$ " (9mm) or $\frac{1}{2}$ " (12mm)

Color

Each panel can be manufactured with a different color

Digital Print

Custom graphics and textures can be printed on panels



SPECIFICATIONS

Patterns

20 standard patterns available.

Sizes

Available in one size:

- 47.5" (1207mm) × 95" (2413mm)

Thickness

Available in two standard thicknesses:

- 3/8" (9mm) | ±0.5mm
- 1/2" (12mm) | ±0.5mm

Composition

100% PET (min. %50 recycled content)

Product Variances

Variation in fiber mix and colour may occur. All products will be supplied within commercial tolerances.

Cleaning

Remove dust and dirt with a stiff plastic bristle brush. Distilled water can be used to remove stains. Always use a soft, clean cloth and blot dry. Vacuuming works great as well.

Fire Testing

- North America:
 - ASTM E-84 Class A*
 - CAN ULC S102-10
- Europe and UK:
 - EN13501-1: 2007

Installation

Can be installed or suspended from open deck ceilings or from standard T bar ceilings. Check with local building code authorities for allowable applications.

Acoustics

Refer to ASTM C423 test chart for specific absorption rates/frequency.

- 3/8" (9mm): NRC 0.75 (subject to mounting conditions and geometrical properties)
- 1/2" (12mm): NRC 0.85 (subject to mounting conditions and geometrical properties)

USGBC LEED v4 Credits

While individual products do not 'earn' LEED credits, ezoBord can contribute to the following LEED v4 Credits. Please refer to the USGBC LEED credit guides for detailed requirements.

- EQc9 for enhancing acoustic performance
- MRc3 BPDO for sourcing of raw materials for recycled contribution
- EQc6 interior lighting for surface reflectance (lighter color options).

Environment

Made of polyester fiber, min. 50% of which comes from recycled water bottles which contributes to LEED MR Credit and BREEAM Health and Wellbeing, Materials points due to recycled content, acoustic performance, and low emitting materials. No VOC's: CDPH v1.2 and REACH SVHC Compliant.



* Upon request, 1/2"(12mm) sheet material is treated with USA origin post-production flame retardant to Class A surface burning characteristics. Post sheet production FR treatment does not contain any Red List Restricted Chemicals and complies with California Proposition 65. Contact customer service for technical information, test data and safety data sheets for flame retardant.

NOISE REDUCTION - 3/8" (9mm)

Constructed from
3/8" (9mm) ezoBord

Divider Pattern
Galaxy

SOUND ABSORPTION COEFFICIENTS (ASTM C423-17)

NRC	SAA	125	250	500	1000	2000	4000
0.60	0.61	0.37	0.43	0.50	0.65	0.85	0.98

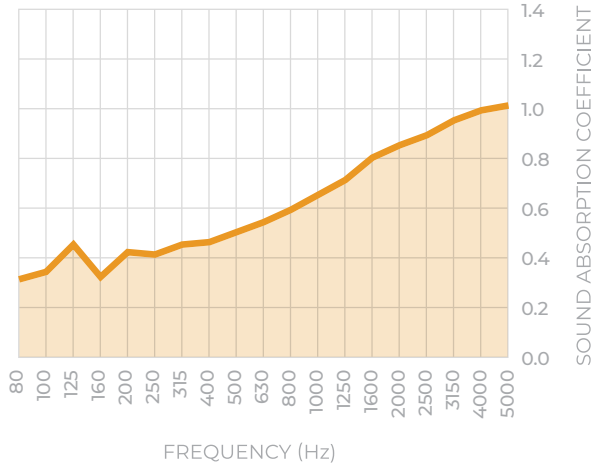

STANDARD COLORS - 3/8" (9mm)



PB09
PURE BLACK



CG06
CHARCOAL GRAY



ES07
EBONY SLATE

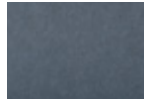

DG34
DARK GRAY



SG04
SILVER GRAY

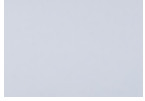

CW04
CLASSIC WHITE

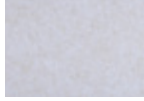

LB01
LIGHT BEIGE

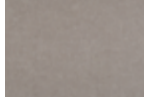

DS10
DESERT SAND



SD18
SUNNY DAYS



TO24
TIGER ORANGE



RR28
RUBY RED



DP30
DEEP PURPLE



MN12
MIDNIGHT NAVY



PI14
POLAR ICE



GA41
GREEN APPLE

STANDARD COLORS - 1/2" (12mm)



PB09
PURE BLACK



CG06
CHARCOAL GRAY



BG07
BOLD GRAY



EG11
ELEPHANT GRAY

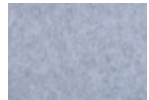

SG04
SILVER GRAY



CW04
CLASSIC WHITE



DS10
DESERT SAND



TB35
TREE BARK



SD18
SUNNY DAYS

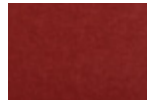

BR34
BRICK RED



GV36
GRAPE VINE



RB08
ROYAL BLUE



PI14
POLAR ICE



OB14
OCEAN BLUE





MG10
MOSS GREEN



CONNECT WITH US

www.ezoBord.com

 [@ezobord](https://www.instagram.com/ezobord)

 [@ezobord](https://twitter.com/ezobord)

 [linkedin.com/company/ezobord](https://www.linkedin.com/company/ezobord)

ezoBord is a registered trademark of iVekter Inc.

USA

Ayrsonics Midwest LLC
170 Prairie Lake Rd
East Dundee, IL 60118
1-800-517-0686
sales@mw.ayrsonics.com

CANADA

Ayrsonics Inc.
825 Trillium Drive
Kitchener ON N2R 1J9
1-844-441-1122
sales@ayrsonics.com

UNITED KINGDOM

ezoBord UK LTD
Unit 20
Westwood Business Park
Margate, Kent, CT9 4JJ
+44 7981 111236
sales@ezobord.co.uk